

NIOSH BViewer

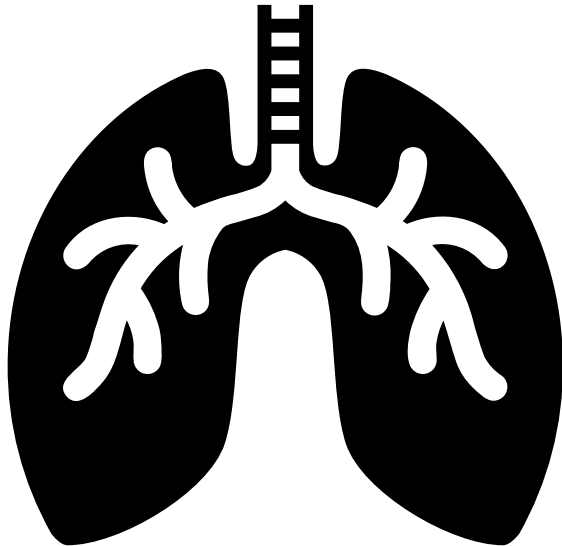

Use the NIOSH BViewer software to view chest radiographs and create ILO classification reports for detecting pneumoconiosis. You can also use Bviewer to see sample radiographs from the B Reader syllabus to study for the exam.

The following slides show steps on how to install and start using the NIOSH BViewer and syllabus radiographs.

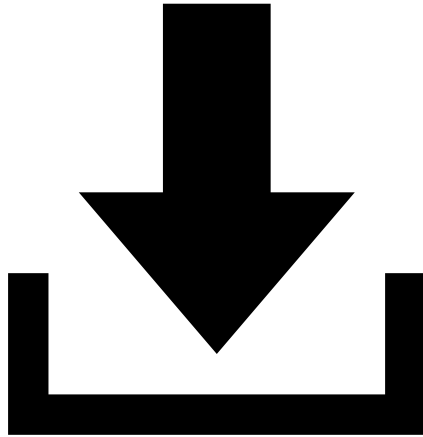

Download Files

Parts of the NIOSH Study Syllabus require you to install software and radiographs. **You will need to view or download each part.** Click on each link from these instructions to save the files to your Downloads folder.

- Download the [NIOSH BViewer](#) (Windows only). All B Reader Exams given at NIOSH Morgantown, WV utilize NIOSH BViewer software.
- Download the [Syllabus and ILO Standard Radiographs for BViewer only](#).
- Download the [Syllabus Radiograph Answer Keys](#) (PDF).
- Download the [Blank Radiograph Classification Form](#) (PDF).

NOTE: It is easier to study on a workstation with multiple monitors or a wide screen. You will likely have several windows or browser tabs open to toggle between the syllabus, sample radiographs, standards, and answer keys.

Download Files

- Right click on the Windows Start button.
- Open the File Explorer.

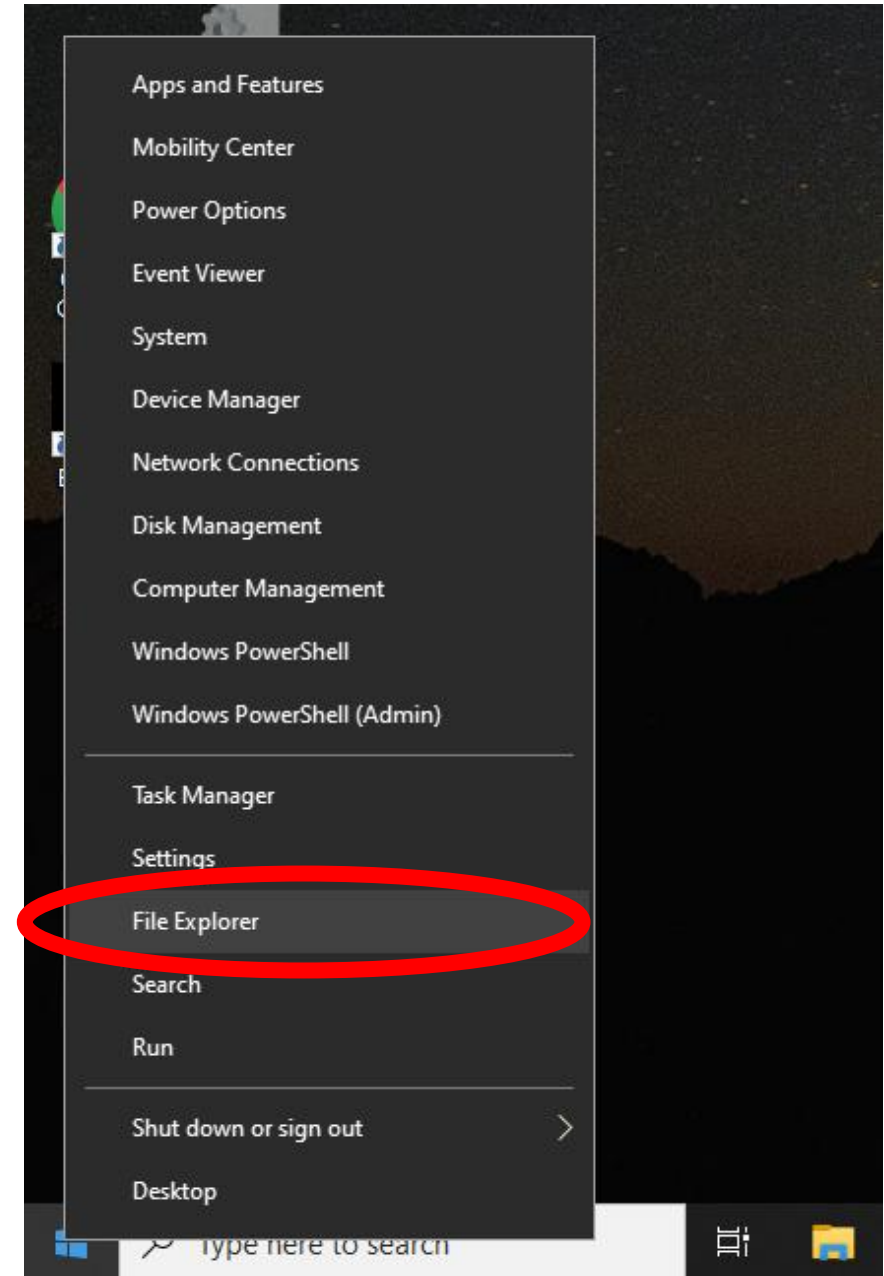

Download Files

- Locate the Downloads folder under Quick Access or This PC.
- Click on Downloads.

You should see the 2 files that you downloaded earlier, along with other downloads on your computer.

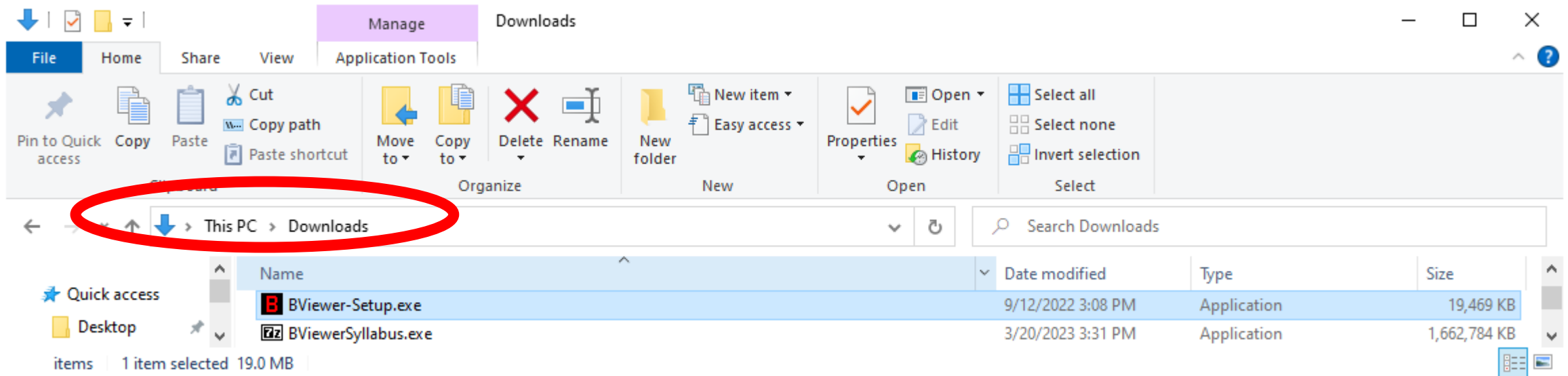

Install BViewer

- Open BViewer-setup.exe from the Downloads folder.
- Install in the default folder "C:\Program Files (x86)\BViewer\.
- Click Next

You will need administrator rights to install BViewer.

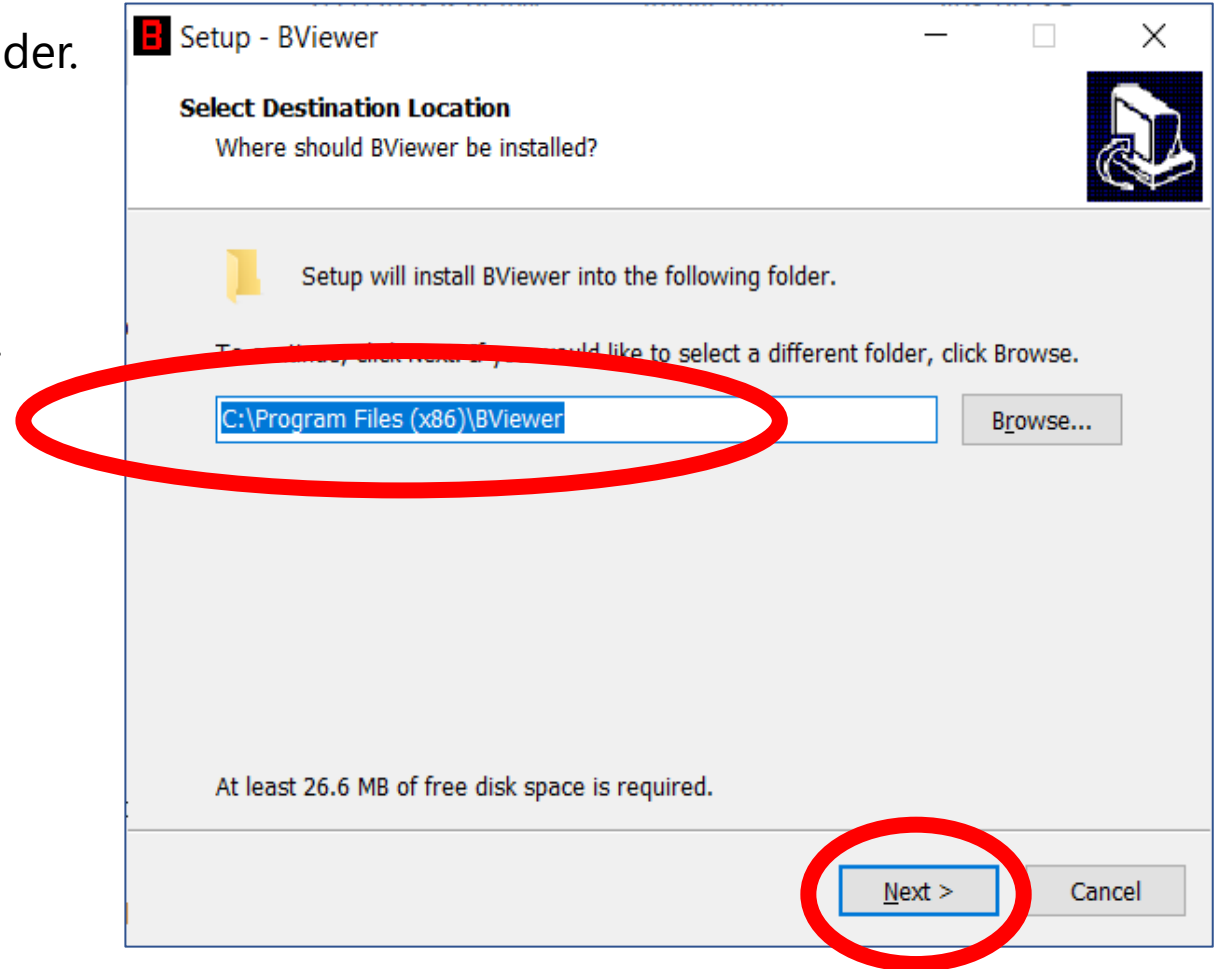

Install BViewer

BViewer will create a desktop icon and quick launch icon.

- Click Next

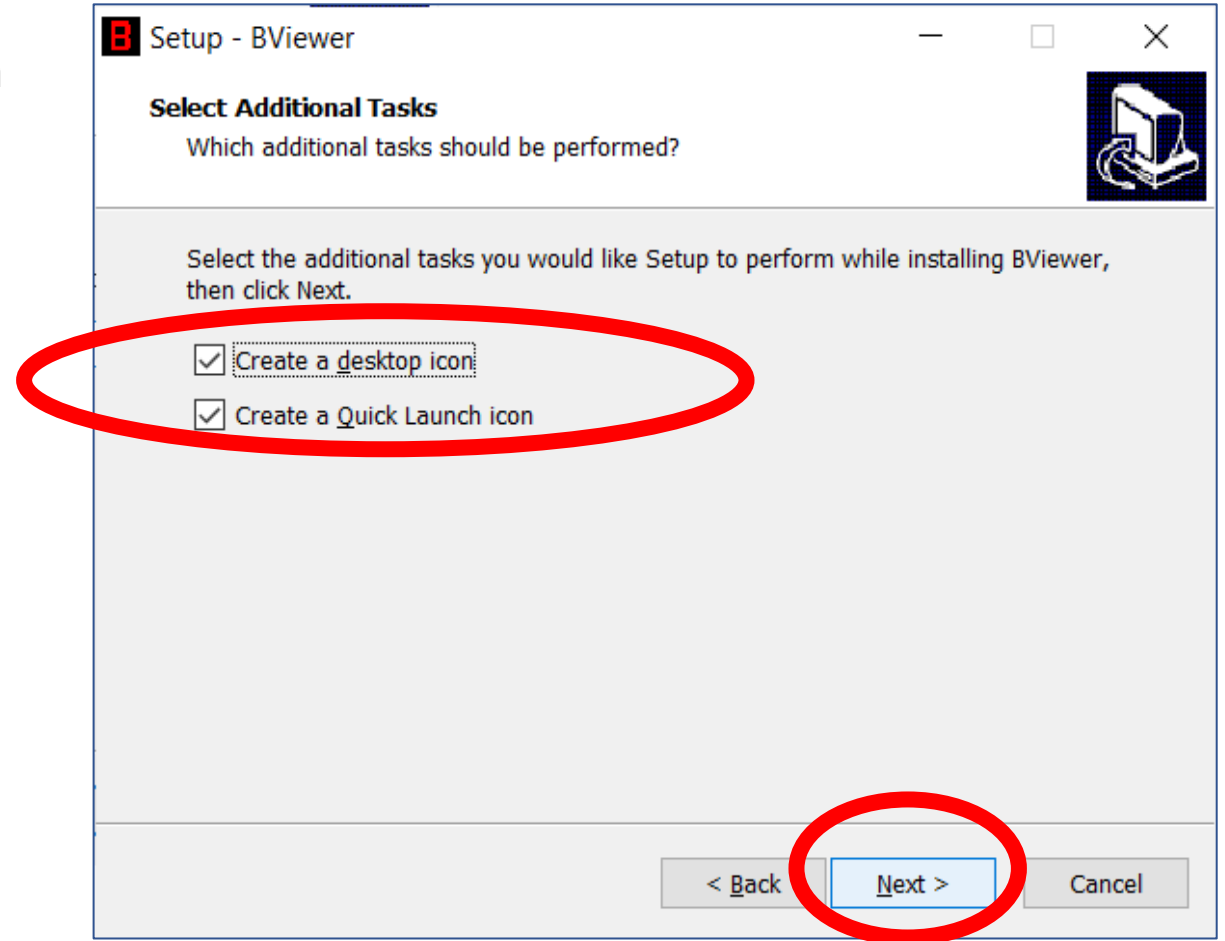

Install BViewer

BViewer is now ready to install.

- Click Install

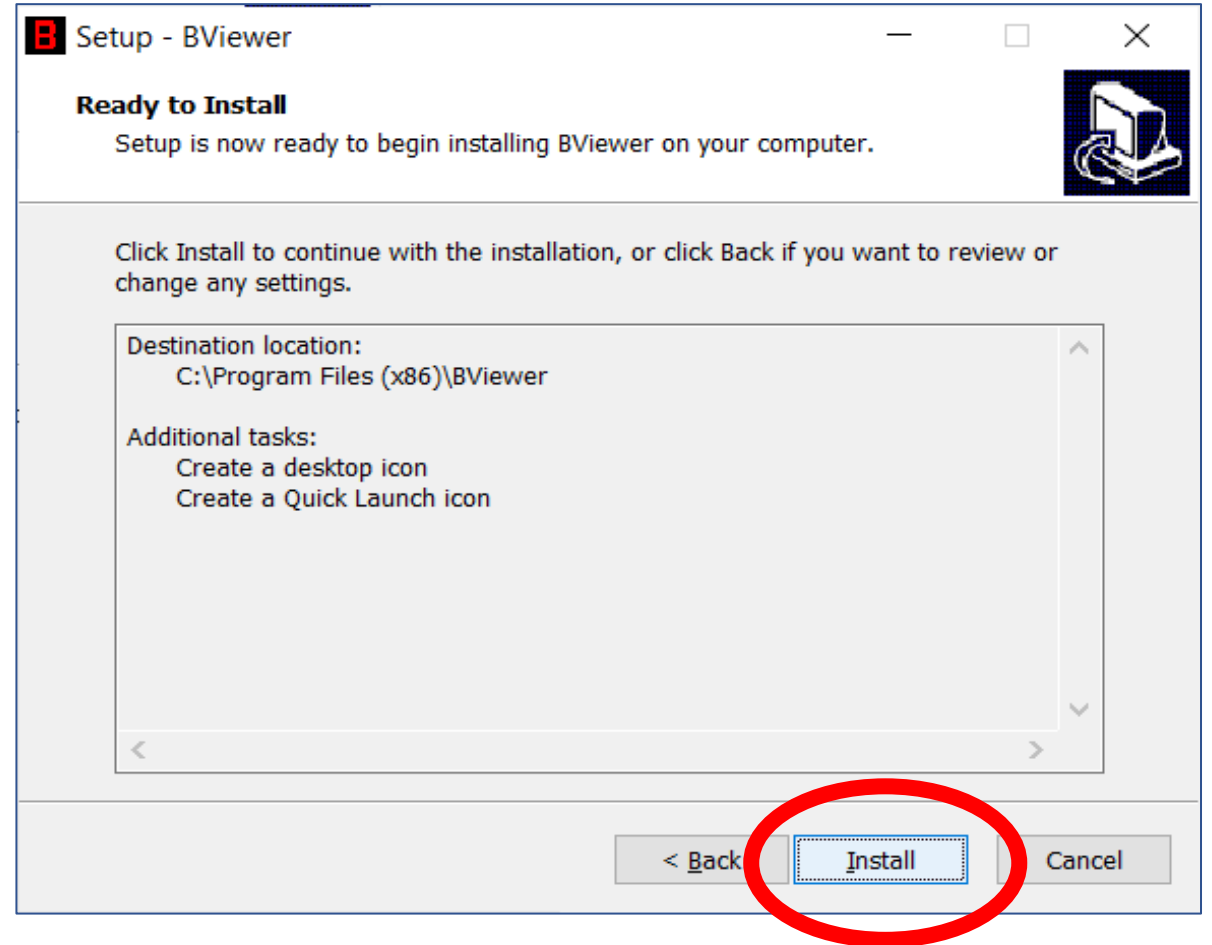

Install BViewer

- Click Finish to close the installer.

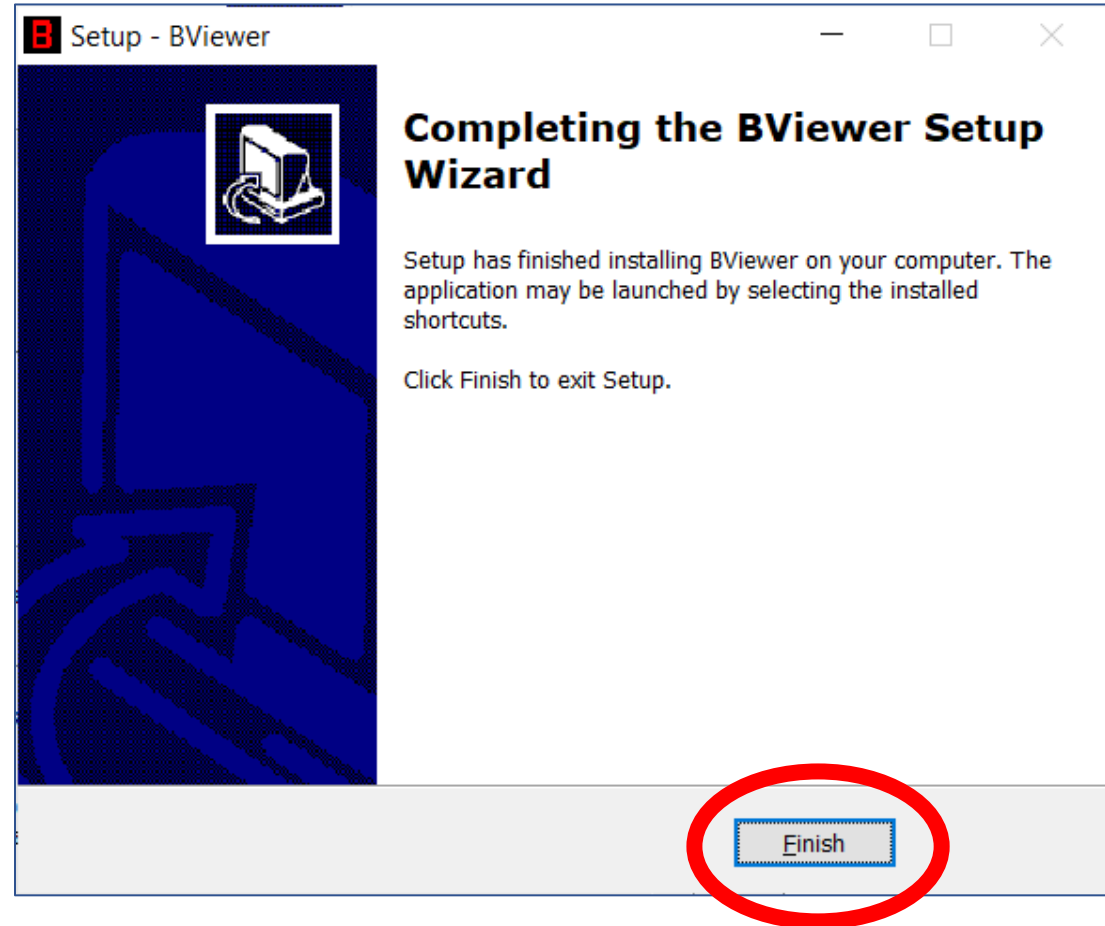

Install Syllabus & ILO Standard Radiographs

- Open BViewerSyllabus.exe from the Downloads folder.

This is a self extractable 7-Zip file that will install the radiographs in BViewer.

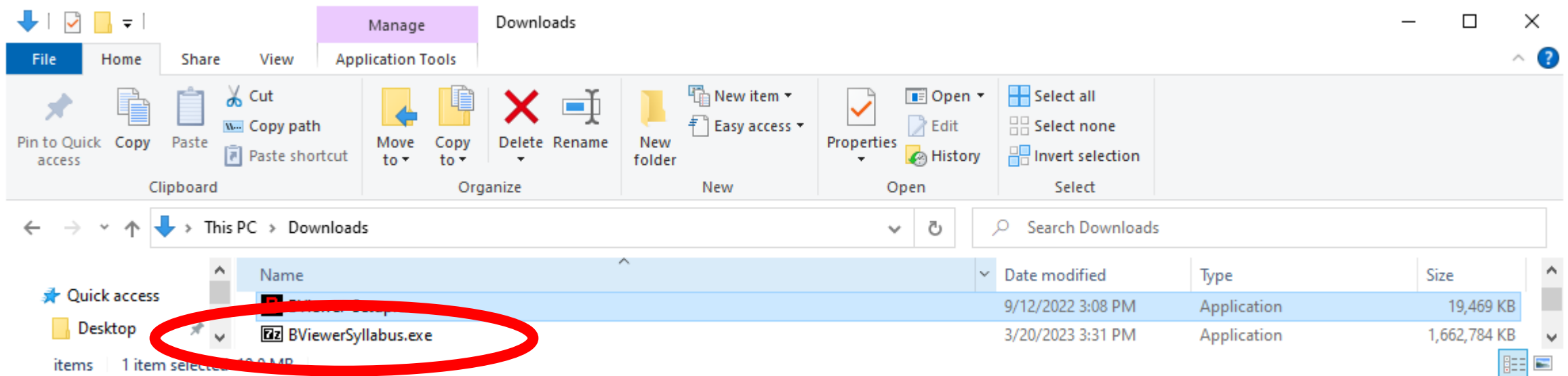

Install Syllabus & ILO Standard Radiographs

- Change the destination folder to C:\.
- Click Extract

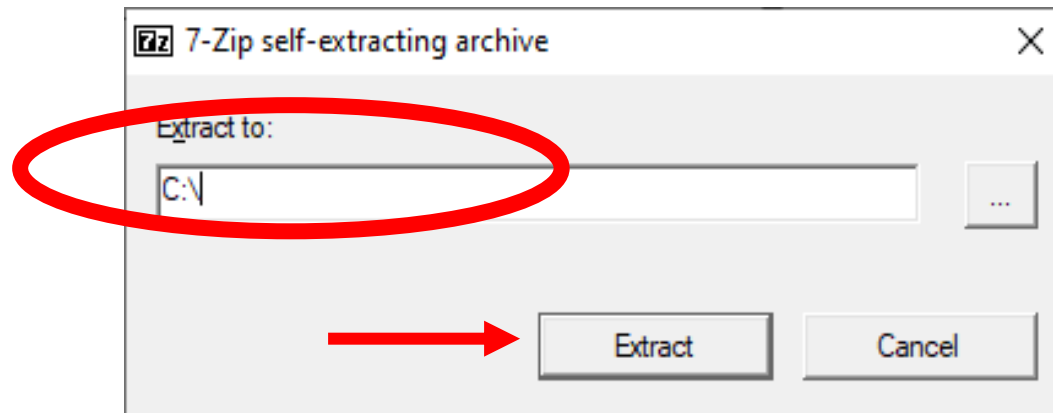

Open BViewer

- Open BViewer from the Windows Start Menu.
- Click OK on the disclaimer.

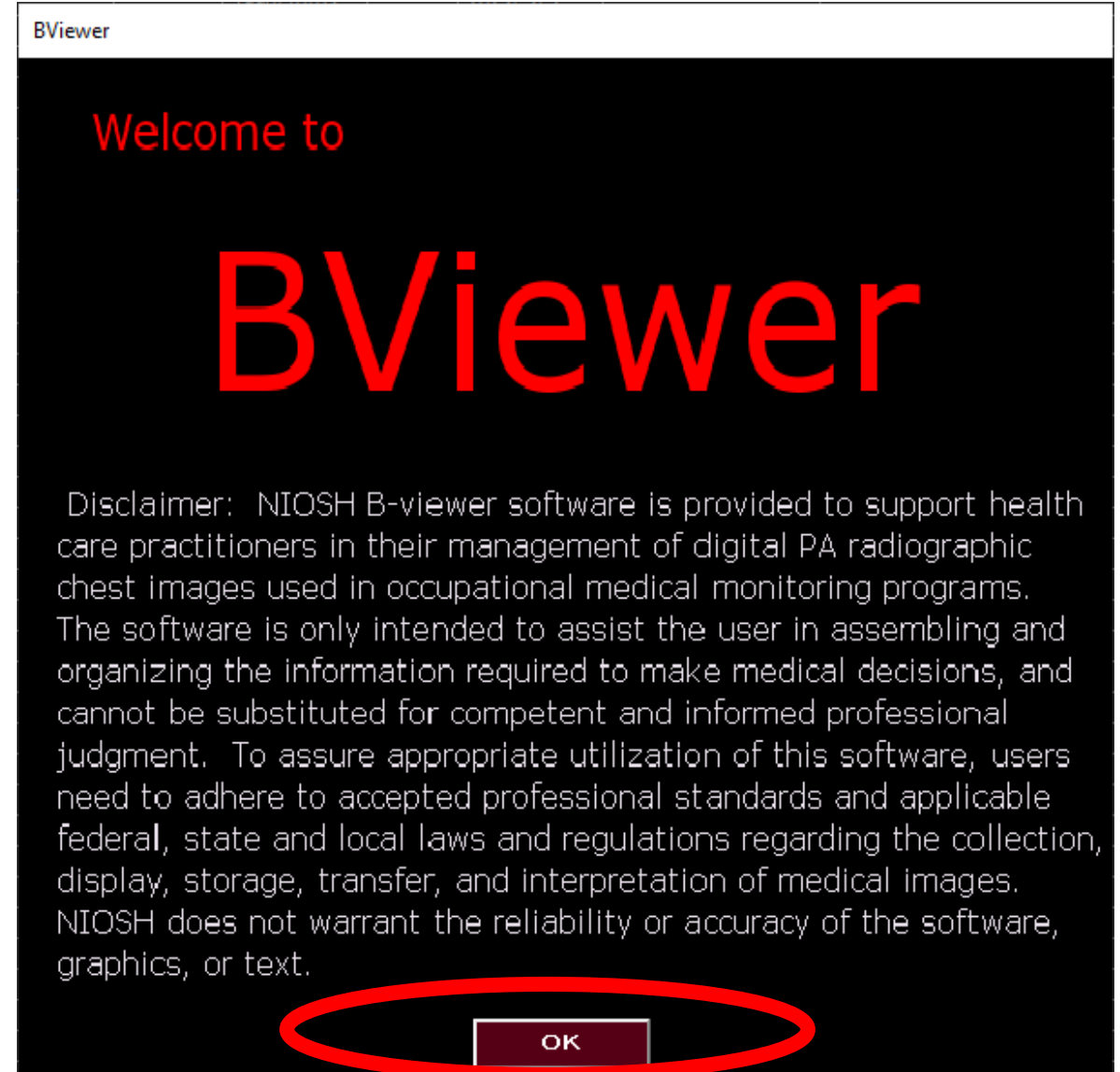
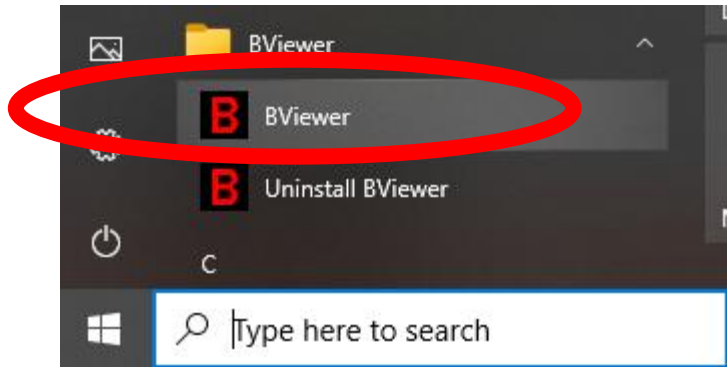

Setup BViewer

Under Reader Identification:

- Enter a last name only.
- Enter a full name only.

Everything else can be left blank for the syllabus.

Viewing and Manipulating Images

- View User Manual starting with Viewing and Manipulating Images.

BViewer 1.2r Control Panel

Remove Checked Studies Import Studies from Local Data Add Newly Added Images Exit BViewer BRetriever is Awake Enter Data to Compose a Study

Select Subject Study Enter Interpretation Produce Report View Log Set Up BViewer View User Manual

Last Name	First Name	ID	Accession	Study Date	Study Date Read	Physician	Study ID	Study Description	Study Instance UID
<input type="checkbox"/> 01p		01p		1996/10...	//			NIOSH B Reader Sy...	1.2.840.113654.2.7C
<input type="checkbox"/> 01q		01q		2005/10...	085... //			NIOSH B Reader Sy...	1.2.840.113654.2.7C
<input type="checkbox"/> 01r		01r		2006/11...	144... //			NIOSH B Reader Sy...	1.2.840.113654.2.7C
<input type="checkbox"/> 01s		01s		2004/05...	085... //			NIOSH B Reader Sy...	1.2.840.113654.2.7C
<input type="checkbox"/> 01t		01t		2005/03...	113... //			NIOSH B Reader Sy...	1.2.840.113654.2.7C
<input type="checkbox"/> 01u		01u		2014/05...	113... //			NIOSH B Reader Sy...	1.2.840.113654.2.7C
<input type="checkbox"/> 02normal		02normal		2008/08...	085... //			NIOSH B Reader Sy...	1.2.840.113654.2.7C
<input type="checkbox"/> 02p		02p		1992/09...	//			NIOSH B Reader Sy...	1.2.840.113654.2.7C
<input type="checkbox"/> 02q		02q		2005/04...	083... //			NIOSH B Reader Sy...	1.2.840.113654.2.7C
<input type="checkbox"/> 02r		02r		2004/11...	090... //			NIOSH B Reader Sy...	1.2.840.113654.2.7C
<input type="checkbox"/> 03n		03n		2001/02...	105... //			NIOSH B Reader Sy...	1.2.840.113654.2.7C
<input type="checkbox"/> 03s		03s		1999/03...	//			NIOSH B Reader Sy...	1.2.840.113654.2.7C
<input type="checkbox"/> 03t		03t		1998/04...	084... //			NIOSH B Reader Sy...	1.2.840.113654.2.7C
<input type="checkbox"/> 03u		03u		2010/02...	170... //		1	NIOSH B Reader Sy...	1.2.804.114118.2.2C
<input type="checkbox"/> 04A		04A		2001/02...	105... //			NIOSH B Reader Sy...	1.2.840.113654.2.7C
<input type="checkbox"/> 04B		04B		1993/02...	//			NIOSH B Reader Sy...	1.2.840.113654.2.7C
<input type="checkbox"/> 04C		04C		1996/10...	//			NIOSH B Reader Sy...	1.2.840.113654.2.7C
<input type="checkbox"/> 04D		04D	13	2019/06...	000... //		1	NIOSH B Reader Sy...	1.2.840.113654.2.7C
<input type="checkbox"/> 05A		05A		2001/02...	105... //			NIOSH B Reader Sy...	1.2.840.113654.2.7C
<input type="checkbox"/> 05B		05B		2003/03...	085... //			NIOSH B Reader Sy...	1.2.840.113654.2.7C
<input type="checkbox"/> 05C		05C		2006/12...	083... //			NIOSH B Reader Sy...	1.2.840.113654.2.7C
<input type="checkbox"/> 05D		05D		2010/02...	084... //			NIOSH B Reader Sy...	1.2.840.113654.2.7C
<input type="checkbox"/> 06A		06A		2001/02...	105... //			NIOSH B Reader Sy...	1.2.840.113654.2.7C
<input type="checkbox"/> 06B		06B		2004/05...	085... //			NIOSH B Reader Sy...	1.2.840.113654.2.7C
<input type="checkbox"/> 06C		06C		2003/02...	144... //			NIOSH B Reader Sy...	1.2.840.113654.2.7C
<input type="checkbox"/> 06D		06D		2001/08...	085... //			NIOSH B Reader Sy...	1.2.840.113654.2.7C
<input type="checkbox"/> AAPM	Test	TG18-2002 ...	2002...	2002/11...	185... //	AAPM ...	2K-MULTI	Multi Purpose 2K ...	2.16.124.113543.60
<input type="checkbox"/> AAPM	Test	TG18-2002 ...	2002...	2002/11...	185... //	AAPM ...	2K-MULTI	Multi Purpose 2K ...	2.16.124.113543.60
<input type="checkbox"/> AAPM	Test	TG18-2002 ...	2002...	2002/11...	162... //	AAPM ...	1K-LUMIN	Luminance 1K ...	2.16.124.113543.60

Sample Workstation

Below is a picture of a BViewer workstation.

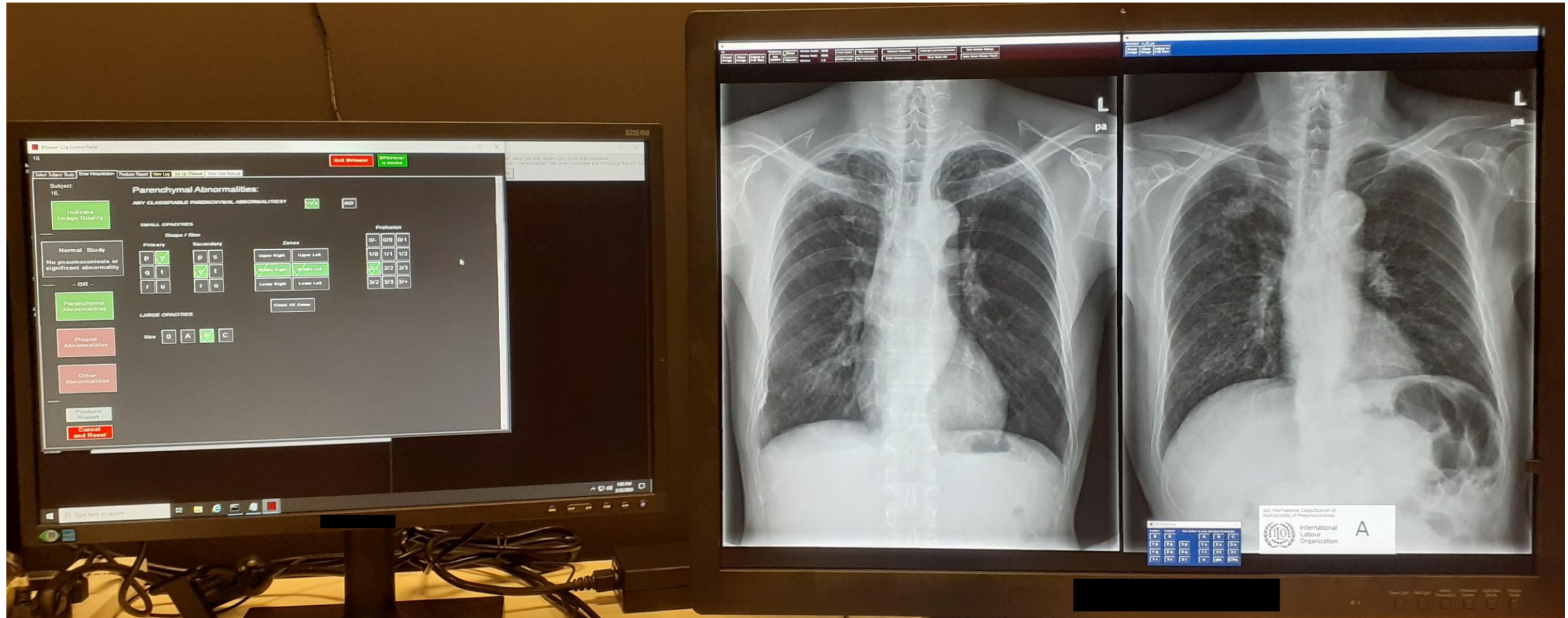

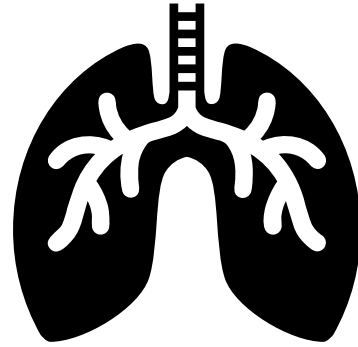

This is the end of the BViewer instructions.

Questions? Contact CWHSP@cdc.gov.